

Ball Valve

PFA / FEP / PVDF lined ball valves (Globe valves) are made to confirm international standards like BS, ASA and DIN. They are available in two designs.

- ⊕ Two piece confirming to BS 5351 (Short Pattern)
- ⊕ Three Piece confirming to BS 5351 (Long Pattern)

Application

- ⊕ Petrochemicals
- ⊕ Chemical
- ⊕ Pharmaceuticals
- ⊕ Food Processing

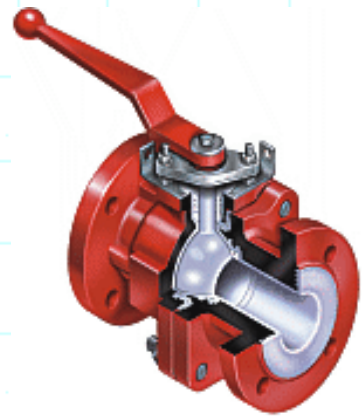

Contact Information Polycoat Flowchem

Telephone : 91-79-274 6754

FAX : 91-79-274 5754

9, Minanagar, Vastral Road, Amraiwadi, Ahmedabad-380 026, India

E mail polycoat@vsnl.com

* Teflon, Tefzel are registered trade mark of Dupont, USA

2 Piece

2 Piece Lined Ball Valves

- ⊕ Two piece ball valves are shorter in length and confirms to BS 5351. Short Pattern.
- ⊕ In this kind of design stem is integral part of Ball, hence lining on ball is prevented from shear in case of excessive torque.
- ⊕ Flanges are drilled according to ANSI B 16.5 or it could be as per customer specifications.
- ⊕ All Polycoat valve are coated with high quality, corrosion resistant polyurethane paint.
- ⊕ Construction material could be customized to the specific need of the customer.

TEFLON LINED TWO PIECE BALL VALVE

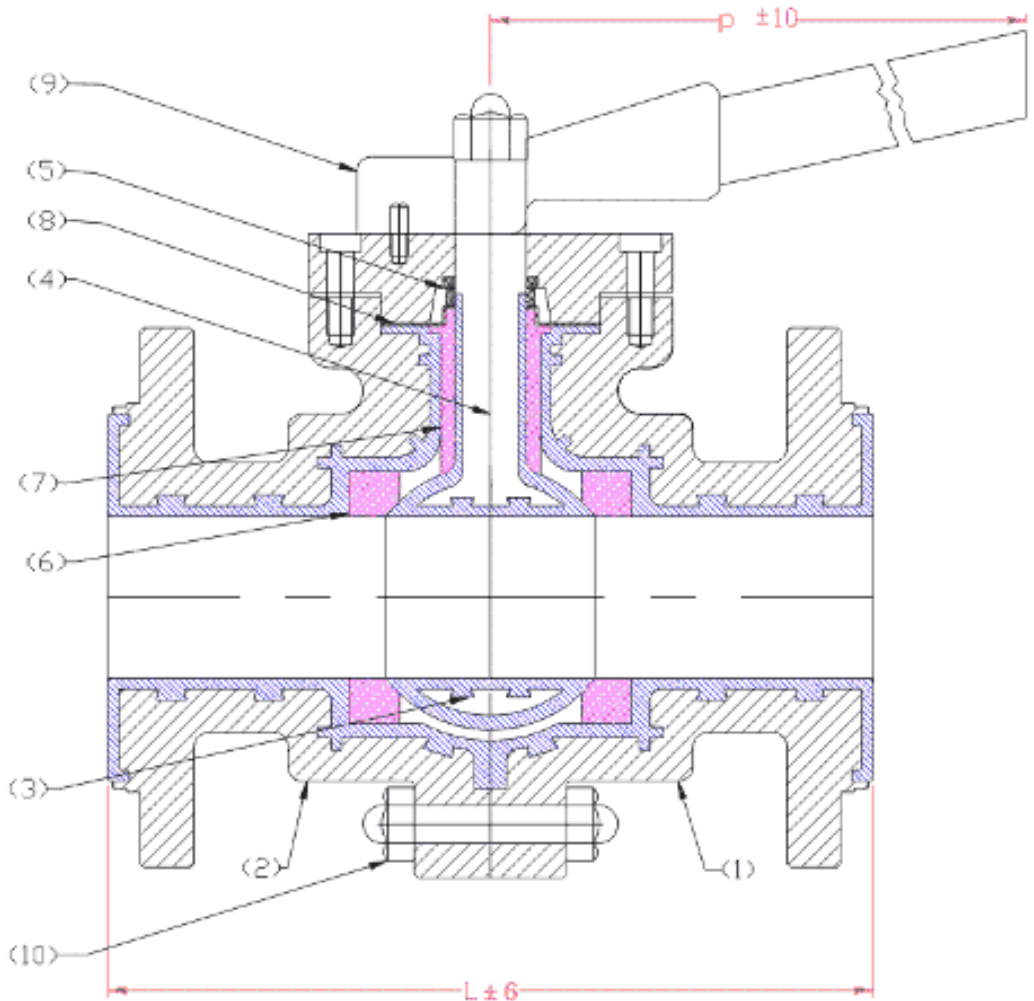

Dimension Chart

SIZE	25	40	50	80	100	150	200	250	300
L	127	165	178	203	229	267	297	330	358
P	270	276	280	285	300	350	360	380	400

Bill Of Material

Sr.No.	PART NAME	MATERIAL
1	CENTER PIECE	ASTM A 216 GR WCB
2	SIDE PIECE	ASTM A 216 GR WCB
3	BALL	TEFLON WITH METAL CORE
4	STEAM	TEFLON LINED CARBON STEEL
5	GLAND	S.S.
6	SEAT RING	PTFE/ TEFLON
7	GLAND PACKING	PTFE/TEFLON
8	GLAND WASHER	S.S.
9	CAP & HANDLE	M.S. OR S.S.
10	STUD & NUTS	S.S.

LINING SPECIFICATION	
LINING MATERIAL	FEP /PFA / PVDF
LINING THICKNESS	3 MM ALL WETTED PARTS
TEMPERATURE WITHSTAND	FEP : 205°C Max. PFA : 265°C Max.

TEST PRESSURE	
BODY	20 Kg / Cm ²
SEAT	10 Kg / Cm ²
SPARK TEST	15 KVDC

Contact Information Polycoat Flowchem

Telephone : 91-79-274 6754

FAX : 91-79-274 5754

9, Minanagar, Vastral Road, Amraiwadi, Ahmedabad-380 026, India

E mail polycoat@vsnl.com

* Teflon, Tefzel are registered trade mark of Dupont, USA

3 piece

3 Piece PFA, FEP, PVDF Lined Ball Valves

- ⊕ 3 Piece ball valves are classic design, conforming to BS 5351, long pattern.
- ⊕ Because stem is not integral part of ball, chances of lining on ball getting sheared increases incase of excessive torque.
- ⊕ Flanges are drilled according to ANSI B 16.5 or it could be as per customer specifications.
- ⊕ All Polycoat valve are coated with high quality, corrosion resistant polyurethane paint.
- ⊕ Construction material could be customized to the specific need of the customer.

Ball Valve, 3 piece design

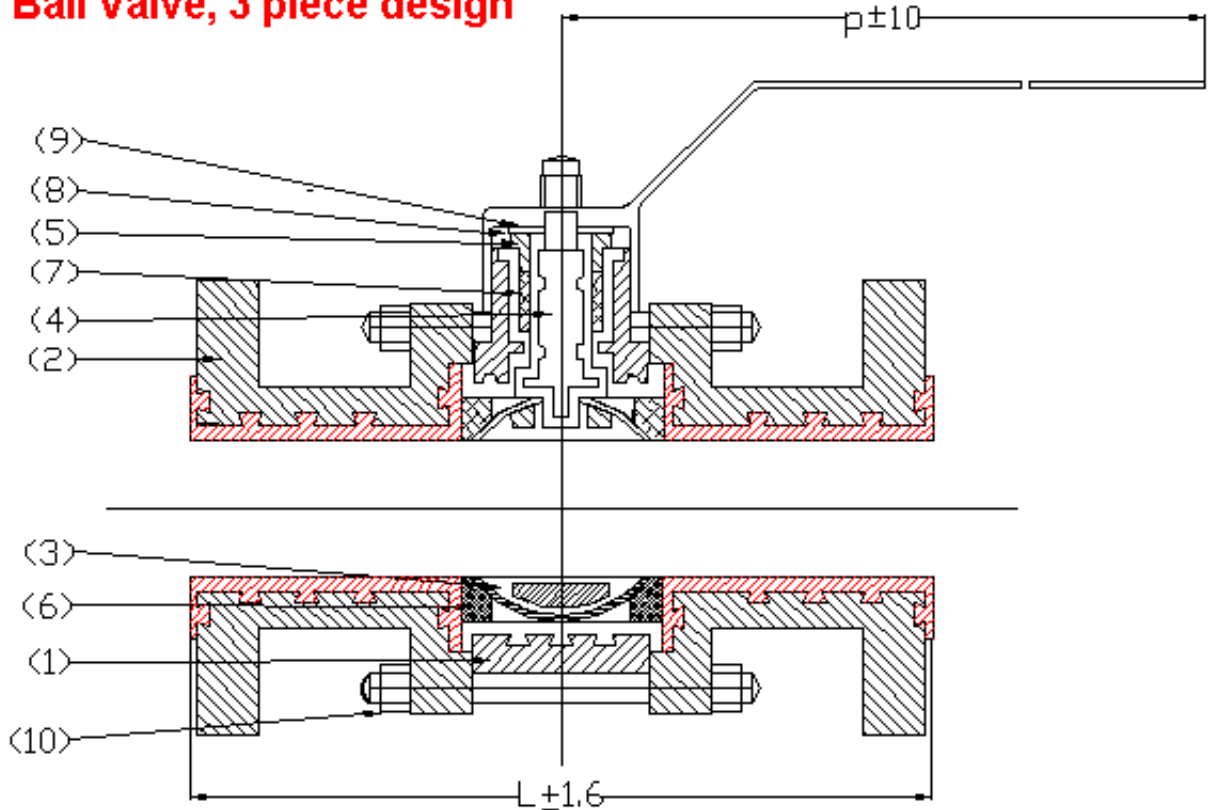

Dimension Chart

SIZE	25	40	50	80	100
L	127	165	203	241	305
P	270	275	280	285	300

Bill Of Material

Sr.No.	PART NAME	MATERIAL
1	CENTER PIECE	ASTM A 216 GR WCB
2	SIDE PIECE	ASTM A 216 GR WCB
3	BALL	TEFLON WITH METAL CORE (Aluminum, SS)
4	STEAM	TEFLON LINED C. STEEL
5	GLAND	S.S.
6	SEAT RING	PTFE/ TEFLON
7	GLAND PACKING	PTFE/TEFLON
8	GLAND WASHER	S.S.
9	CAP & HANDLE	M.S. OR S.S.
10	STUD & NUTS	S.S.

LINING SPECIFICATION

LINING MATERIAL	FEP /PFA / PVDF
LINING THICKNESS	3 MM ALL WETTED PARTS
TEMPERATURE WITHSTAND	FEP : 205°C Max. PFA : 265°C Max.

TEST PRESSURE

BODY	20 Kg / Cm ²
SEAT	10 Kg / Cm ²
SPARK TEST	15 KV DC

All dimensions are in mm, unless specified.

Contact Information Polycoat Flowchem

Telephone : 91-79-274 6754

FAX : 91-79-274 5754

9, Minanagar, Vastral Road, Amraiwadi, Ahmedabad-380 026, India

E mail polycoat@vsnl.com

* Teflon, Tefzel are registered trade mark of Dupont, USA